

REVISIONS		
DATE	NAME	LIC. No.

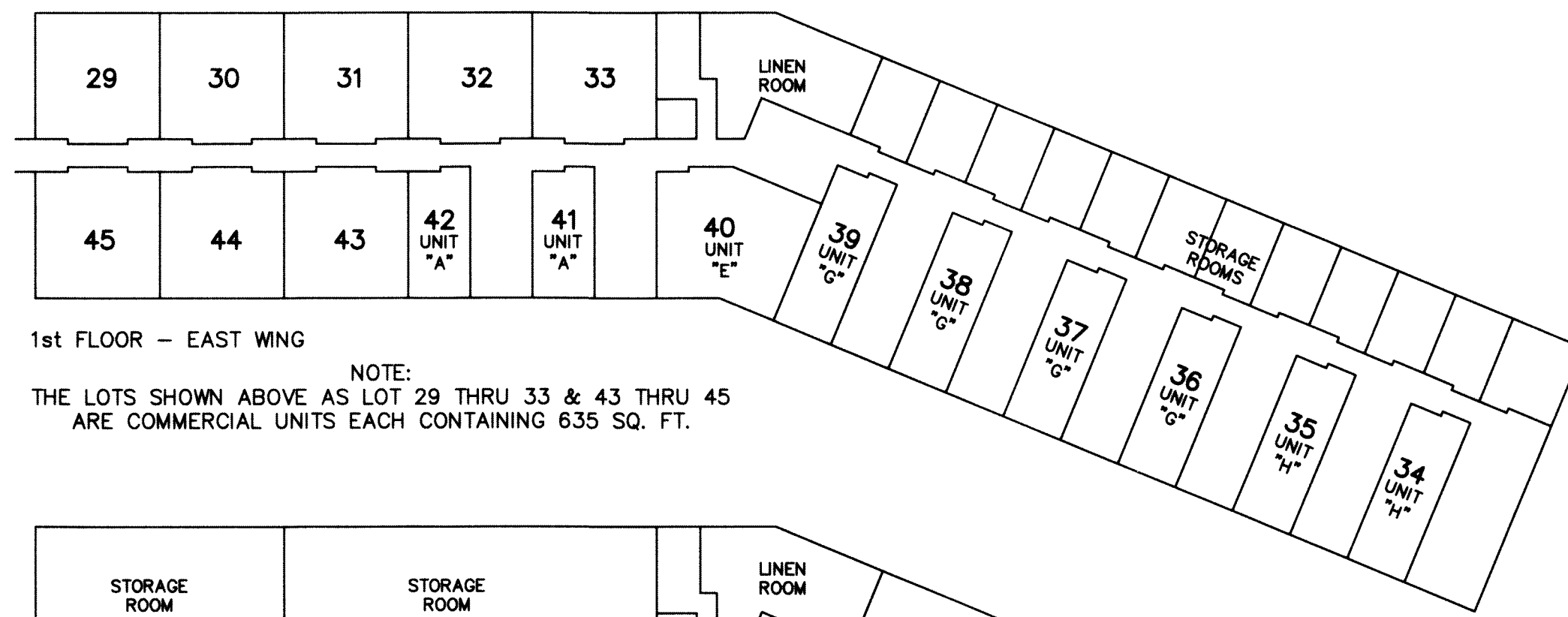

1st FLOOR - EAST WING  
 NOTE:  
 THE LOTS SHOWN ABOVE AS LOT 29 THRU 33 & 43 THRU 45  
 ARE COMMERCIAL UNITS EACH CONTAINING 635 SQ. FT.

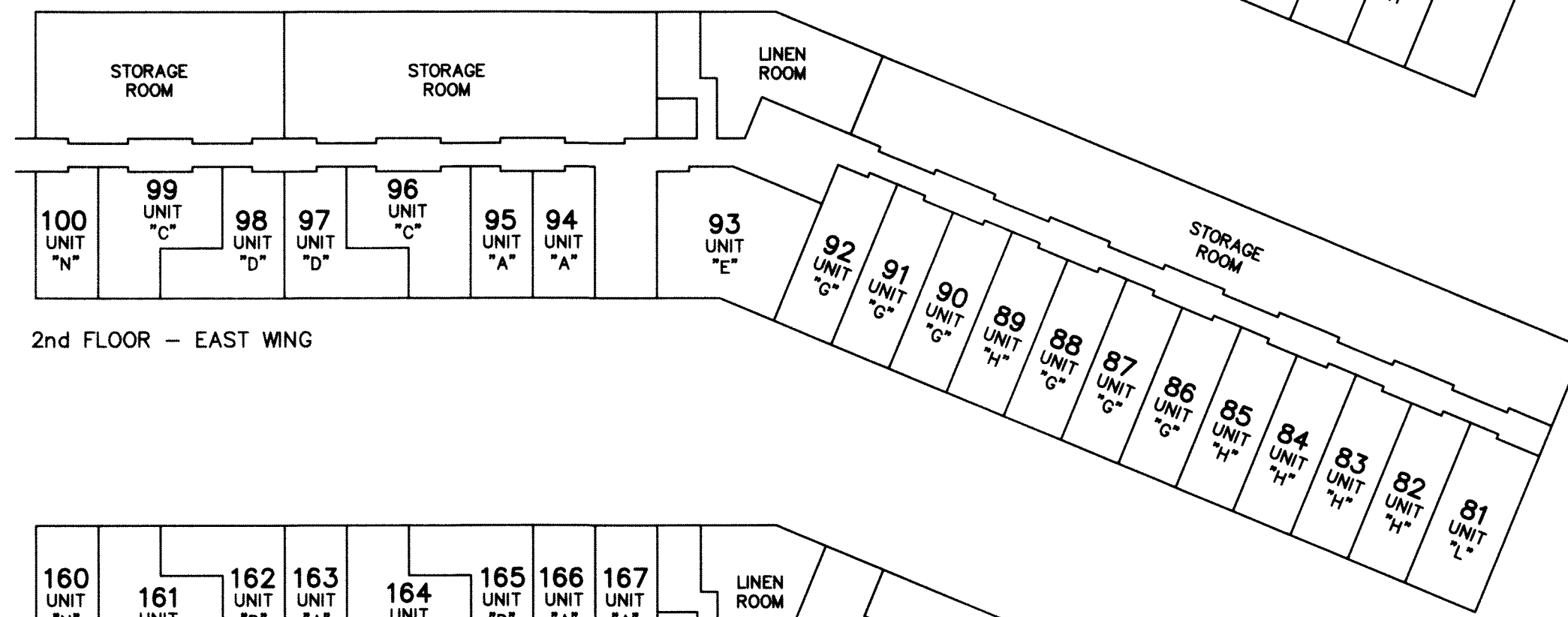

2nd FLOOR - EAST WING

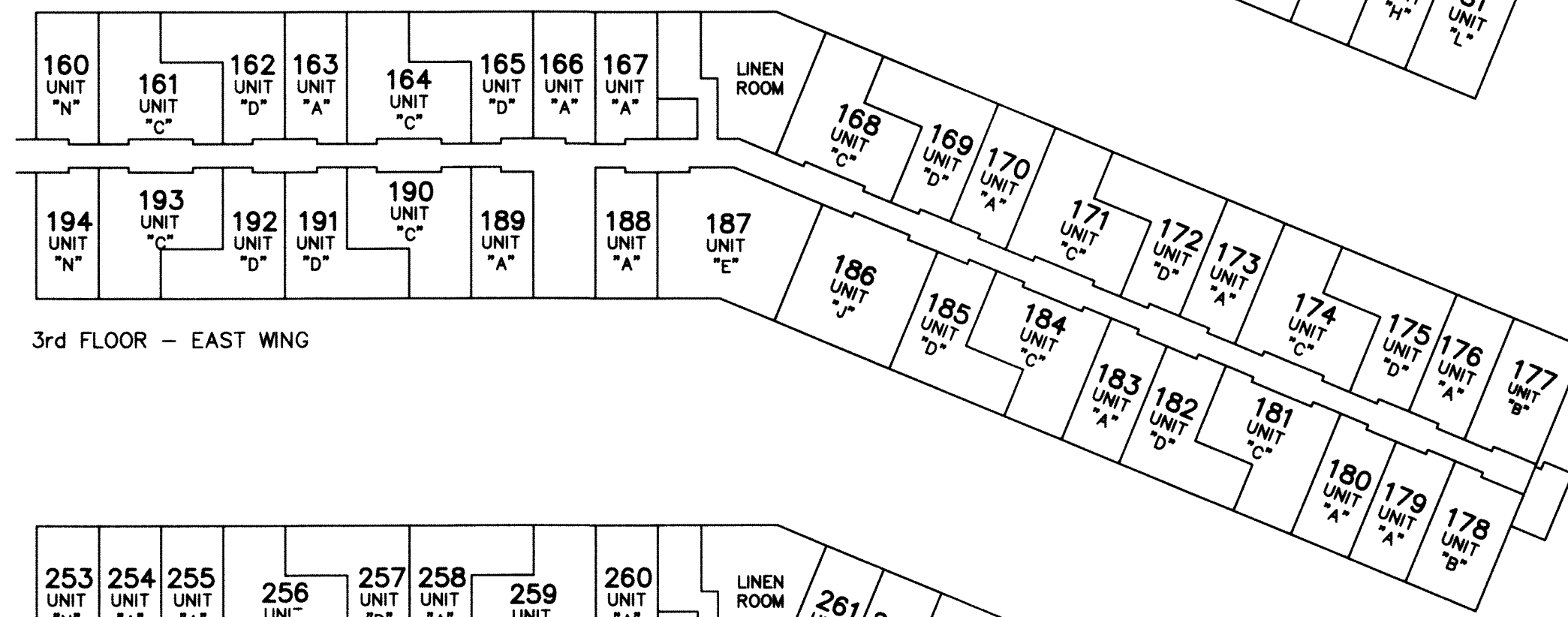

3rd FLOOR - EAST WING

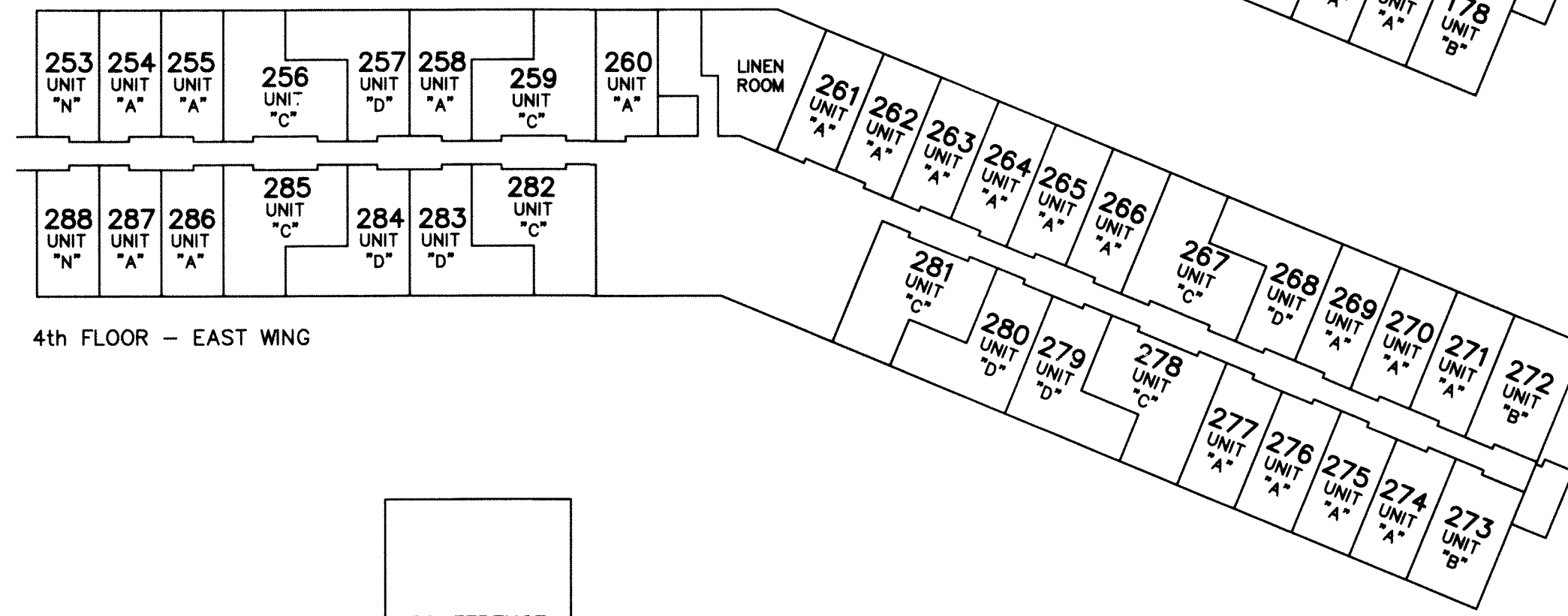

4th FLOOR - EAST WING

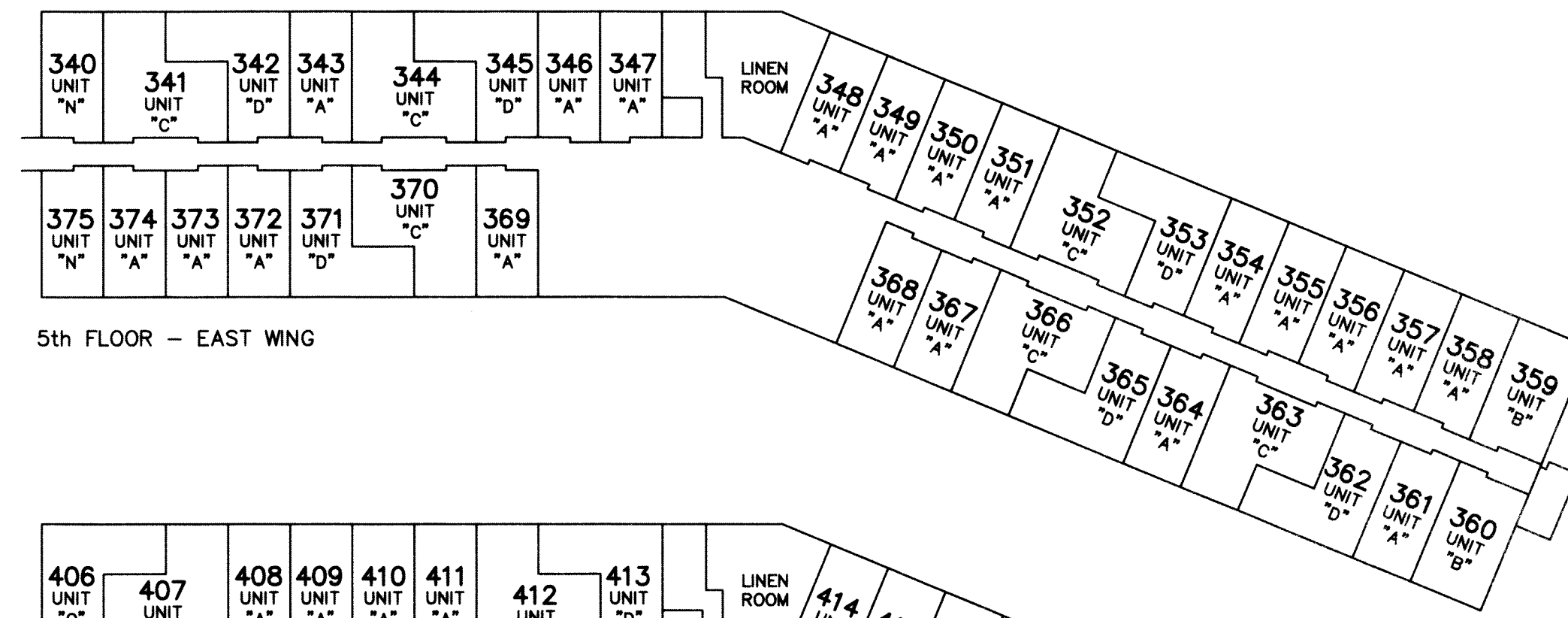

5th FLOOR - EAST WING

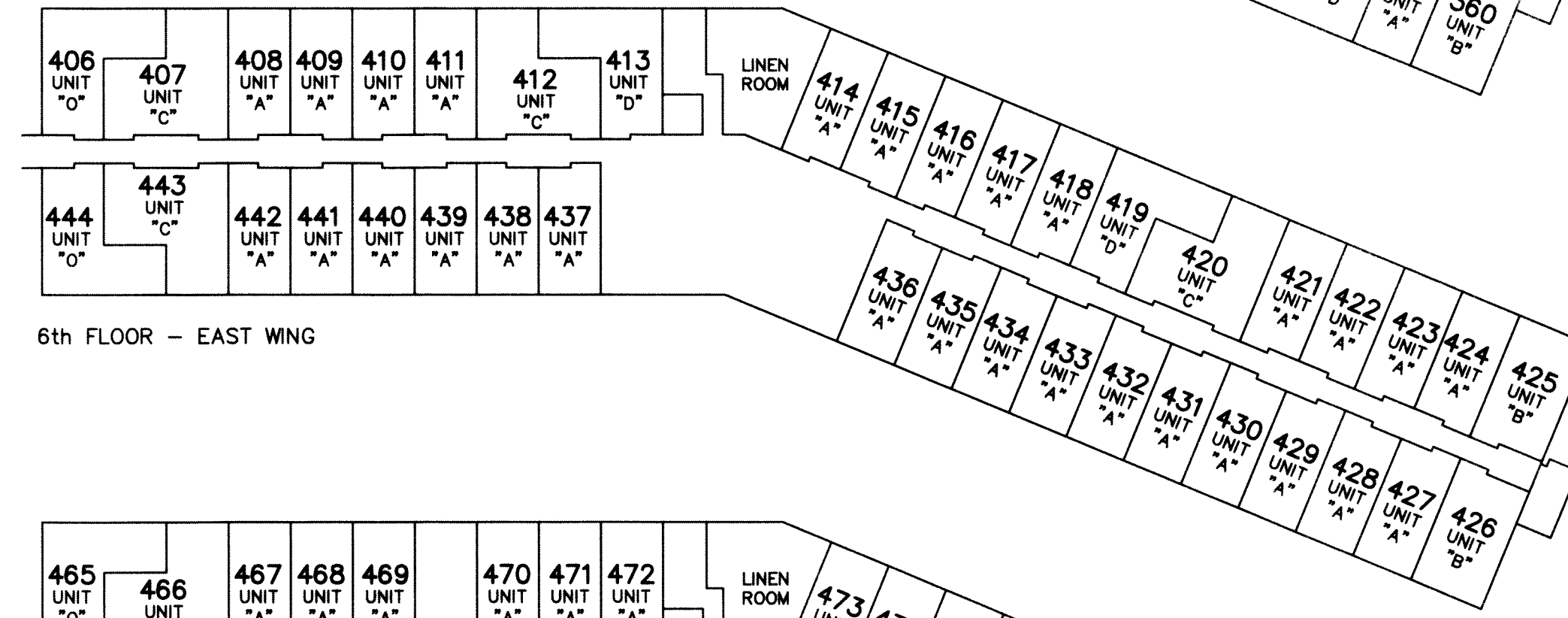

6th FLOOR - EAST WING

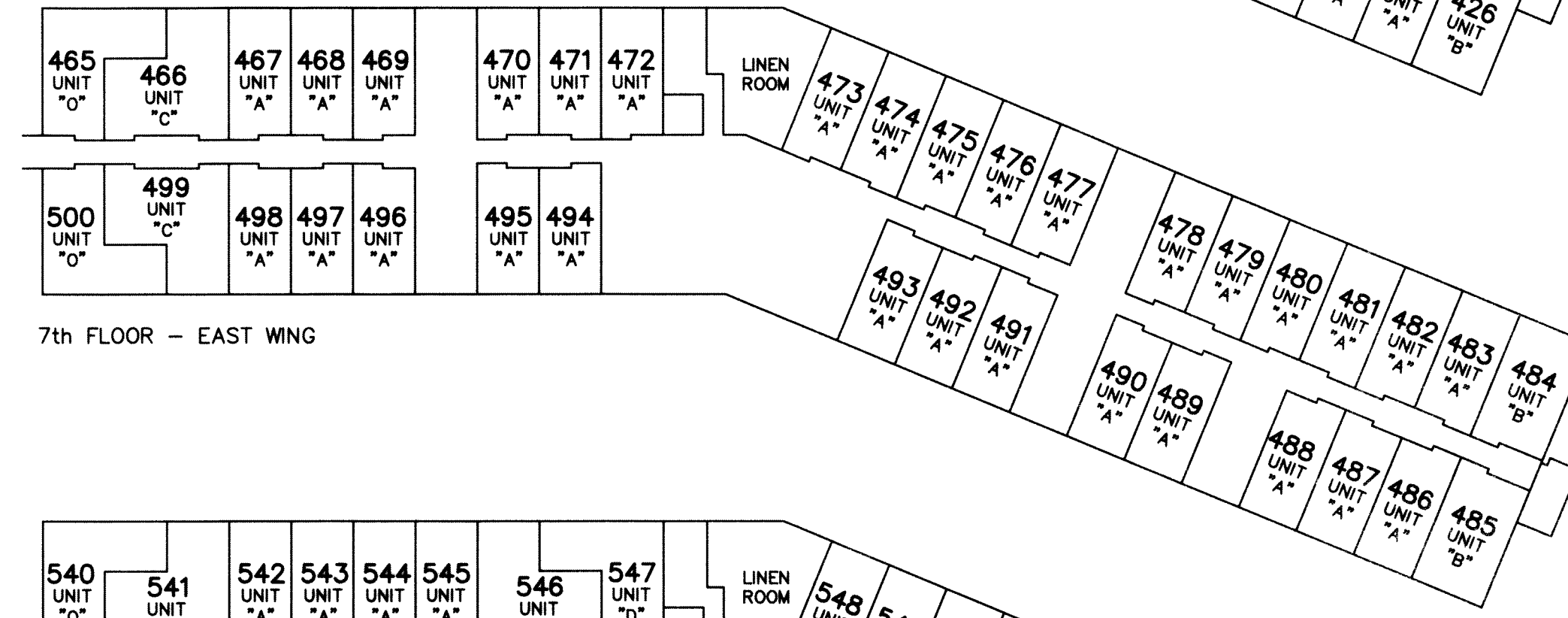

7th FLOOR - EAST WING

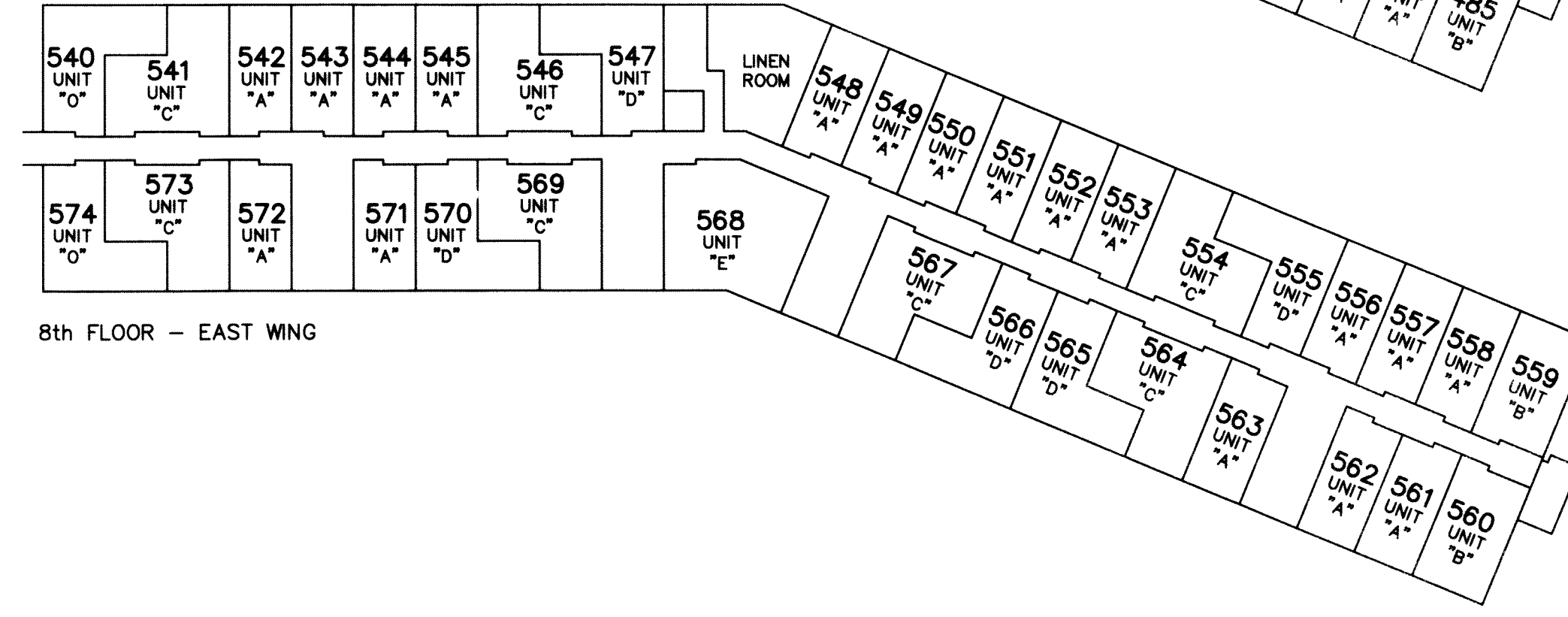

8th FLOOR - EAST WING

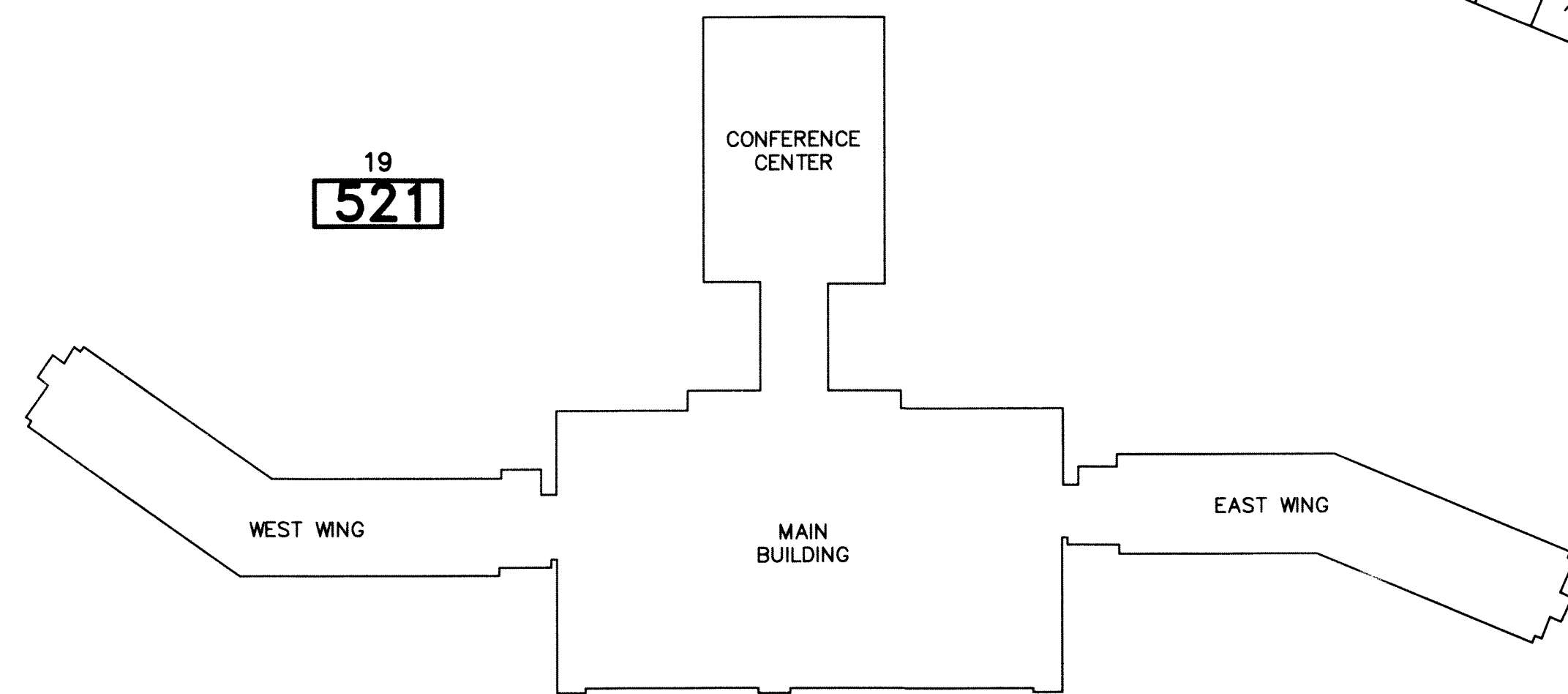

SEASONS AT GREAT GORGE  
 1" = 100'

FLOOR PLANS  
 1" = 30'

This map has been drawn using Computer Aided Drafting/Design (CAD/D) and Coordinated Geometry (COGO).

<p>NEW JERSEY DEPARTMENT OF THE TREASURY          DIVISION OF TAXATION          APPROVED AS A TAX MAP PURSUANT TO THE AUTHORITY OF          N.J.S.A. 54:1-15 AND N.J.S.A. 54:50-1          FOR THE DIRECTOR, DIVISION OF TAXATION  <i>Richard A. Schulz</i>          CHIEF, PROPERTY ADMINISTRATION  <i>Richard A. Schulz</i>          SUPERVISOR, TAX MAPS SECTION, VALUATION AND MAPPING          DATE: FEB 11 2019 SERIAL NO. 1097</p>	<p><b>TAX MAP</b>  <b>TOWNSHIP OF VERNON</b>          SUSSEX COUNTY, NEW JERSEY          SCALE: AS SHOWN NOVEMBER, 2017  <b>RICHARD A. SCHULZ, P.E., P.L.S.</b>          SPATIAL DATA LOGIC          285 DAVIDSON AVENUE          SOMERSET, NEW JERSEY, 08873</p>
---	---