

REVISIONS		
DATE	NAME	LIC. No.

BLOCK NUMBER	LOT NUMBER	UNIT NUMBER	SQ. FT.
UPPER LEVEL			
527	146	518	408
	147	516	290
	148	514	286
	149	512	367
	150	510	367
	151	508	286
	152	506	290
	153	504	290
	154	502	290
	155	503	290
	156	505	290
	157	507	286
	158	509	367
	159	511	367
	160	513	286
	161	515	290
	162	517	290
	163	521	408
	164	523	290
	165	525	286
	166	527	367
	167	529	367
	168	531	286
	169	533	290
	170	535	290
	171	534	408
	172	532	290
	173	530	286
	174	528	367
	175	526	367
176	524	286	
177	522	290	
178	520	408	

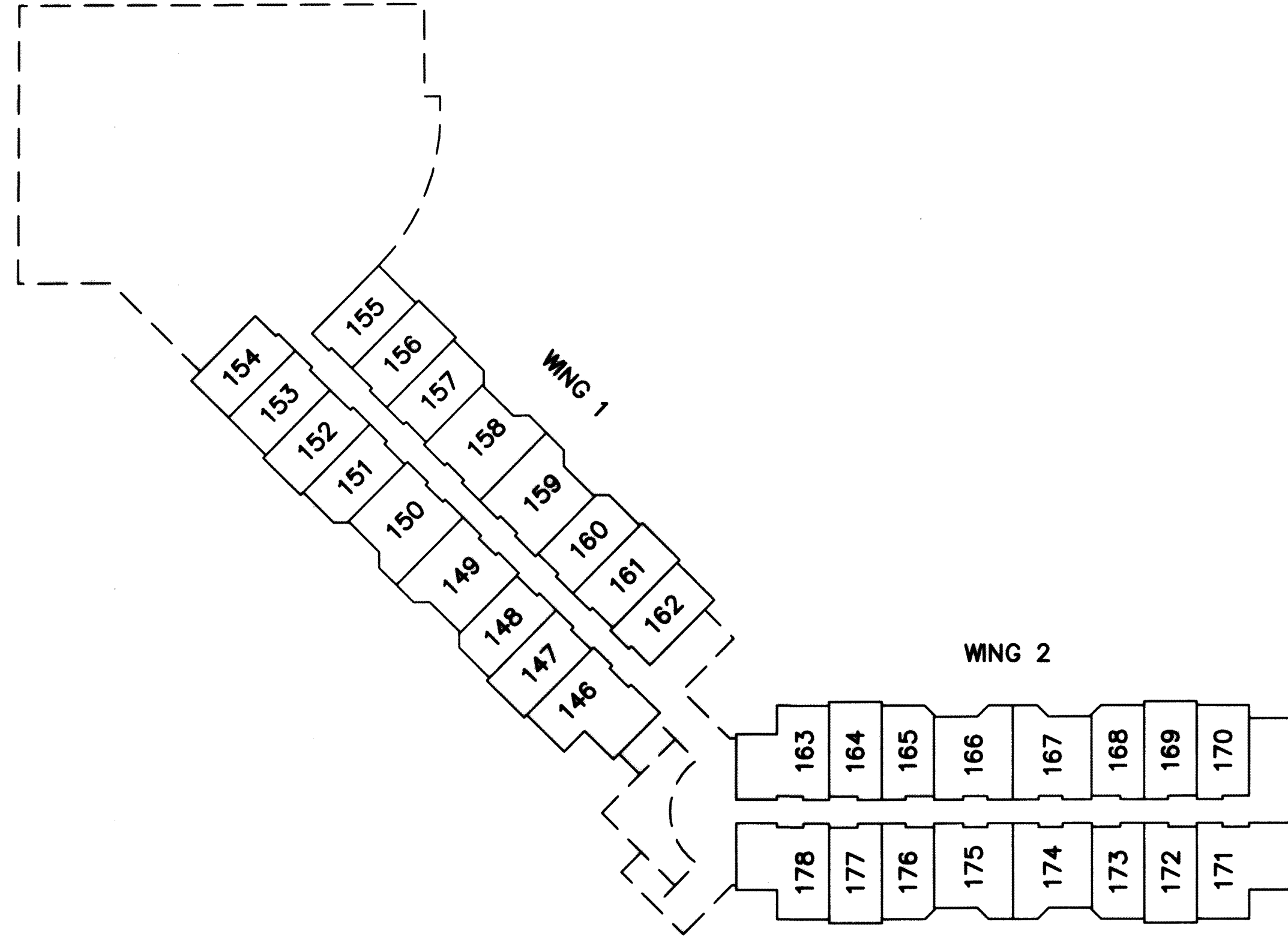

**527**

UPPER LEVEL  
DETAIL VIEW  
1"=30'

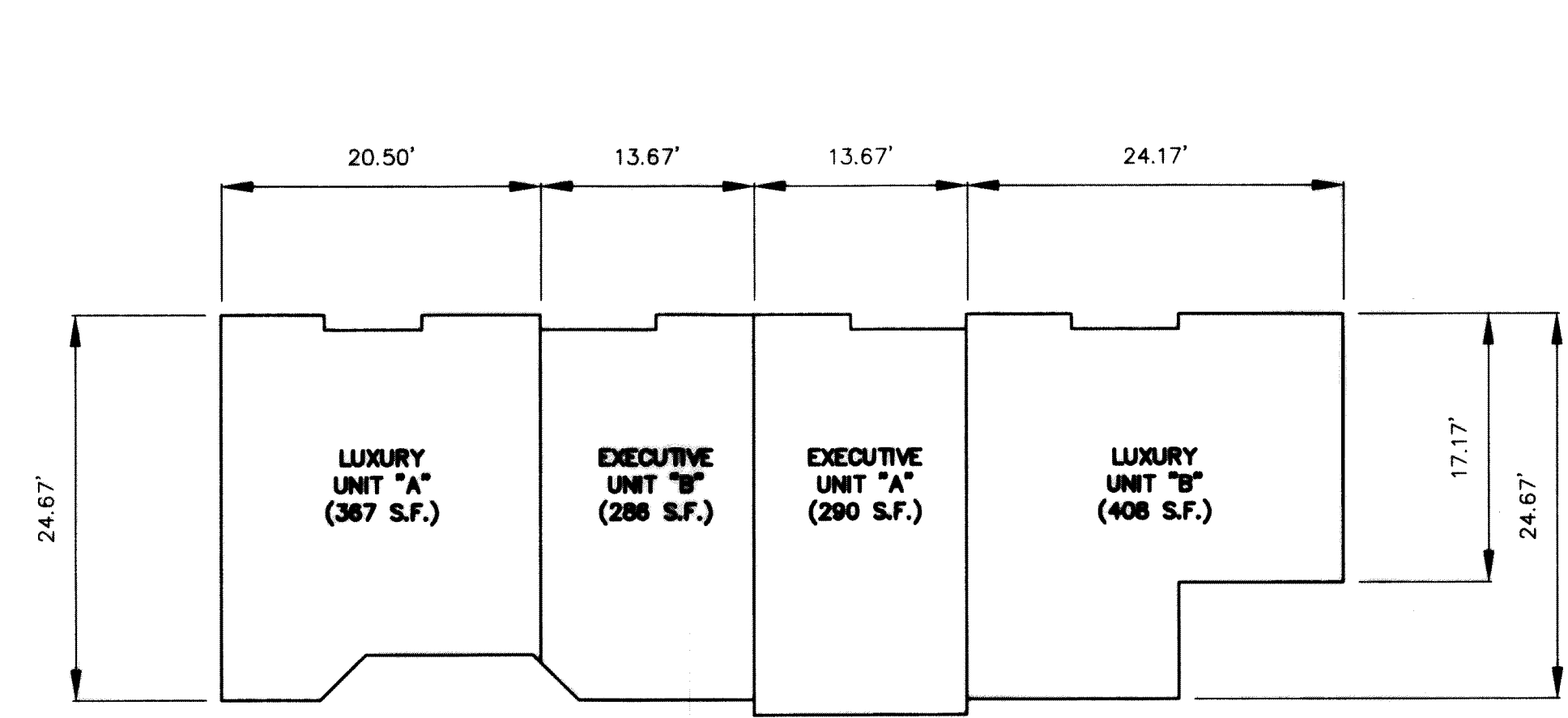

TYPICAL UNIT PLANS  
1"=10'

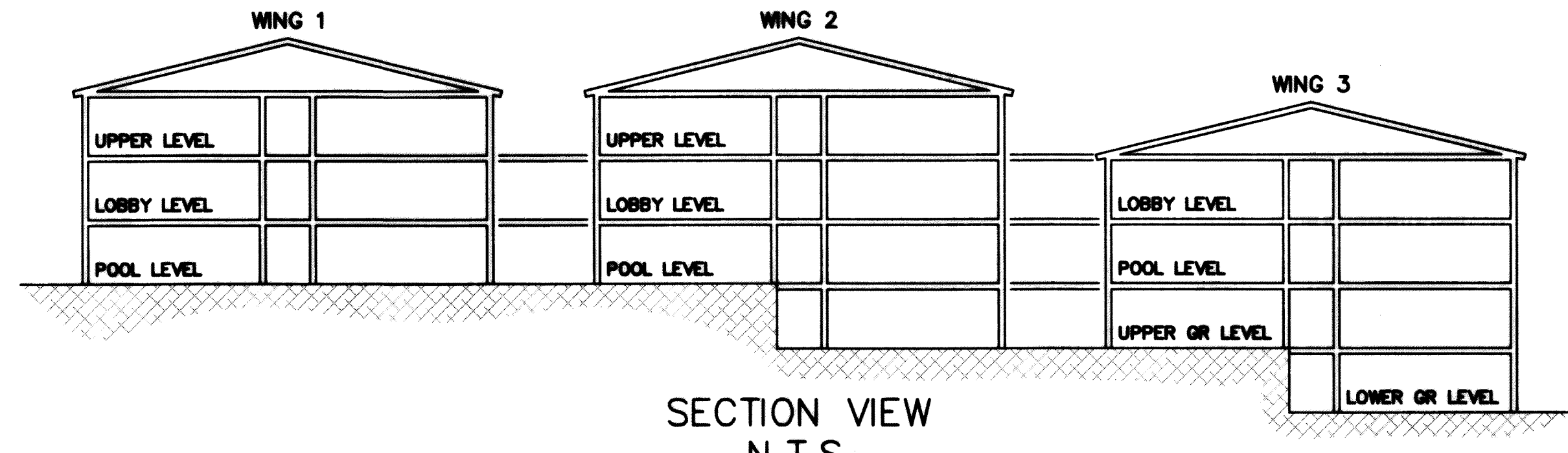

SECTION VIEW  
N.T.S.

NEW JERSEY DEPARTMENT OF THE TREASURY  
DIVISION OF TAXATION  
APPROVED AS A TAX MAP PURSUANT TO THE AUTHORITY OF  
N.J.S.A. 54:1-15 AND N.J.S.A. 54:20-1  
FOR THE DIRECTOR, DIVISION OF TAXATION  
*Richard A. Schulz*  
CHIEF, PROPERTY ADMINISTRATION  
*Richard A. Schulz*  
SUPERVISOR, TAX MAPS SECTION, EVALUATION AND SURVEY  
DATE FEB 11 2010 SERIAL NO. 1097

**TAX MAP**  
**TOWNSHIP OF VERNON**  
SUSSEX COUNTY, NEW JERSEY  
SCALE: AS SHOWN NOVEMBER, 2017  
**RICHARD A. SCHULZ, P.E., P.L.S.**  
SPATIAL DATA LOGIC  
285 DAVIDSON AVENUE  
SOMERSET, NEW JERSEY, 08873

This map has been drawn using Computer Aided Drafting/Design (CAD/D) and Coordinated Geometry (COGO).