

STAGE	SCHEDULE AND PROCEDURE FOR IMPLEMENTATION OF SOIL EROSION AND SEDIMENT CONTROL PHASE 1	APPROXIMATE DURATION
1.	INSTALL SILT FENCE AROUND CONSTRUCTION AREA AS REQUIRED. PROVIDE TEMPORARY CONSTRUCTION ENTRANCES, ESTABLISH ROUGH GRADES AS NECESSARY FOR CONSTRUCTION OF ACCESS DRIVES AND PARKING AREAS ON SITE. PROVIDE TEMPORARY STABILIZATION OF EXPOSED SOIL NOT SUBJECT TO CONSTRUCTION TRAFFIC.	2 WEEKS
2.	AREAS WITHIN LIMITS OF DISTURBANCE FOR CONSTRUCTION SHALL BE CLEARED AND GRUBBED.	3 WEEKS
3.	GRADING OF BUILDING & DRIVEWAY AREA SHALL TAKE PLACE NEXT. IF FOR ANY REASON THE WORK IS STOPPED OR INTERRUPTED AT THIS POINT AND DOES NOT BEGIN FOR A PERIOD OF SEVEN (7) DAYS, THE DISTURBED AREAS WILL IMMEDIATELY RECEIVE A TEMPORARY SEEDING IN ACCORDANCE WITH THESE STANDARDS.	3 WEEKS
4.	BEGIN DEMOLITION OF BUILDING.	NA
5.	A SUBBASE COURSE WILL BE APPLIED IMMEDIATELY FOLLOWING ROUGH GRADING AND INSTALLATION OF IMPROVEMENTS IN ORDER TO STABILIZE DRIVEWAYS, AND PARKING AREAS. IN AREAS WHERE NO UTILITIES ARE PRESENT, THE SUBBASE SHALL BE INSTALLED WITHIN 15 DAYS OF THE PRELIMINARY GRADING. ALL PAVED ROADS MUST BE KEPT CLEAN AT ALL TIMES.	NA
6.	DISTURBED AREAS SHALL BE STABILIZED WITH TEMPORARY DIVERSION BERMS, HAY BALES, GROUND COVER OR OTHERWISE SHOWN ON APPROVED SOIL EROSION PLAN. THIS STAGE SHALL BE STARTED WITHIN THREE (3) DAYS OF THE COMPLETION OF STAGE "4".	1 WEEK
7.	TEMPORARY OR PERMANENT SEEDING AND MULCHING OF ROADWAY AND SLOPE AREAS. THIS STAGE SHALL BEGIN WITHIN SEVEN (7) DAYS AFTER COMPLETION OF STAGE "6".	1 WEEK
8.	INSTALLATION OF STORM DRAINAGE SYSTEM AND OTHER UNDERGROUND UTILITIES SHALL TAKE PLACE NEXT.	NA
9.	INLET FILTERS SHALL BE PLACED AT ALL INLETS AND SHALL BE MAINTAINED UNTIL FINAL STABILIZATION OF EXPOSED AREAS ARE COMPLETED. THIS STAGE SHALL BEGIN IMMEDIATELY UPON COMPLETION OF STAGE "8".	NA
10.	PLACEMENT OF ROADWAY CURBING, SIDEWALKS, AND BASE COURSE SHALL TAKE PLACE NEXT. THIS STAGE SHALL NOT BEGIN UNTIL COMPLETION OF STAGE "6" AND "7".	NA

SOIL EROSION AND SEDIMENT CONTROL NOTES:

- THE DISTRICT SHALL BE REPRESENTED AT THE PRECONSTRUCTION MEETING WITH THE TOWNSHIP ENGINEER, CONTRACTORS, AND UTILITY REPRESENTATIVE. IF THE TOWN ENGINEER DOES NOT SCHEDULE A PRECONSTRUCTION MEETING, IT IS THE RESPONSIBILITY OF THE OWNER/APPLICANT TO SCHEDULE ONE PRIOR TO ANY LAND DISTURBANCE.
- ALL SEDIMENT AND EROSION CONTROL PRACTICES ARE TO BE INSTALLED PRIOR TO ANY MAJOR SOIL DISTURBANCE, OR IN THEIR PROPER SEQUENCE, AND MAINTAINED UNTIL PERMANENT PROTECTION IS ESTABLISHED.
- EXCAVATED SOIL MATERIAL SHALL NOT BE PLACED ADJACENT TO RIVERS, STREAMS OR BODIES OF WATER IN A MANNER THAT WILL CAUSE IT TO BEWASHED AWAY BY HIGH WATER OR RUNOFF. EXCESS BORROW MATERIAL REMOVED FROM THE CONSTRUCTION SITE SHALL BE STABILIZED AT THE SITE OF PLACEMENT.
- ALL DISTURBED AREAS NOT SCHEDULED FOR CONSTRUCTION ACTIVITIES WITHIN 60 DAYS OF DISTURBANCE SHALL BE TEMPORARILY STABILIZED.
- ALL SEDIMENT AND EROSION CONTROL PRACTICES ARE TO BE INSTALLED PRIOR TO ANY MAJOR SOIL DISTURBANCE, OR IN THEIR PROPER SEQUENCE, AND MAINTAINED UNTIL PERMANENT PROTECTION IS ESTABLISHED.
- CONTROL MEASURES FOR NON-GROWING SEASON STABILIZATION OF EXPOSED AREAS WHERE THE ESTABLISHMENT OF VEGETATION IS PLANNED AS THE FINAL CONTROL MEASURE.
- PERMANENT STABILIZATION (LOCATION AND DETAIL OF ALL PROPOSED NONSTRUCTURAL METHODS OF SOIL STABILIZATION- INCLUDING TYPES AND RATES OF LIME, FERTILIZER, SEED, AND MULCH TO BE APPLIED- REFER TO THE N.J. SOIL EROSION AND SEDIMENT CONTROL STANDARDS ENTITLED PERMANENT VEGETATIVE COVER FOR SOIL STABILIZATION).
- ALL WORK TO BE DONE IN ACCORDANCE WITH THE "STANDARDS FOR SOIL EROSION AND SEDIMENT CONTROL IN NEW JERSEY".
- A CRUSHED STONE, VEHICLE WHEEL-CLEANING BLANKET WILL BE INSTALLED WHEREVER A CONSTRUCTION ACCESS DRIVE INTERSECTS A PAVED ROADWAY. THE BLANKET WILL BE OF SUFFICIENT SIZE TO REDUCE OFFSITE TRACKING OF SEDIMENT BY CONSTRUCTION TRAFFIC AND WILL BE MAINTAINED IN GOOD ORDER UNTIL ALL DRIVEWAY AREAS ARE STABILIZED. THE BLANKET SHALL BE COMPOSED OF ASTM C-33, SIZE NO. 2 OR 3, NOT LESS THAN 6" DEEP AND NOT LESS THAN THE FULL WIDTH OF THE POINTS OF INGRESS AND EGRESS.
- MULCHING SHALL BE DONE AT A RATE OF 80 LBS./1000 SQUARE FEET WITH UNROTTED SALT HAY AND ANCHORED IMMEDIATELY AFTER PLACEMENT.
- ALL REVISIONS, AFTER DISTRICT CERTIFICATION HAS BEEN GRANTED, SHALL BE FORWARDED TO SUSSEX COUNTY SCD SOIL CONSERVATION DISTRICT FOR REVIEW. A LETTER OF EXPLANATION SHALL ACCOMPANY ALL REVISIONS.
- THE SUSSEX COUNTY SCD MUST BE NOTIFIED AT LEAST 48 HOURS IN ADVANCE OF ANY LAND DISTURBING ACTIVITY.
- THE OWNER/APPLICANT WILL OBTAIN A DISTRICT ISSUED REPORT OF COMPLIANCE PRIOR TO ANY OCCUPANCY. THE DISTRICT REQUIRES AT LEAST ONE WEEK'S NOTICE BEFORE ISSUANCE.

- ALL TOPSOIL STRIPPED AND STOCKPILED FOR USE IN FINAL GRADING SHALL RECEIVE TEMPORARY SEEDING.
- TOTAL DISTURBED AREA = 0.19 ACRES
- DURING LAND DISTURBANCE ACTIVITIES OR CONSTRUCTION, ANY ADDITIONAL CONTROL MEASURES AS DEEMED NECESSARY TO PREVENT EROSION OF SEDIMENT BEYOND THOSE SHOWN ON THE APPROVED PLANS SHALL BE INSTALLED AS DIRECTED BY THE TOWNSHIP ENGINEER.
- THE APPLICANT IS REQUIRED TO HAVE A COPY OF THE CERTIFIED PLAN AT THE CONSTRUCTION SITE.
- TO THE MAXIMUM EXTENT PRACTICAL, ALL VEGETATED AREAS NOT NEEDED FOR CONSTRUCTION SHALL BE LEFT UNDISTURBED FOR AS LONG AS POSSIBLE.
- FINAL STABILIZATION OF ALL LAND DISTURBANCES ASSOCIATED WITH UNDERGROUND UTILITIES, IRRESPECTIVE OF PHASING, IS THE ULTIMATE RESPONSIBILITY OF THE OWNER.
- DUST IS TO BE CONTROLLED WITH WATER, CALCIUM CHLORIDE OR OTHER METHOD APPROVED BY THE SOIL CONSERVATION DISTRICT.
- RESIDENTIAL DEVELOPMENT CONTROL MEASURES SHALL/WILL APPLY TO DWELLING CONSTRUCTION ON INDIVIDUAL LOTS AND NOTATION THAT SUCH CONTROL MEASURES SHALL APPLY TO SUBSEQUENT OWNERS IF TITLE IS CONVEYED.
- FOR SUBDIVISION PROJECT (ROADWAY & DRAINAGE PLANS) - SOIL EROSION AND SEDIMENT CONTROL PLANS WILL BE DEVELOPED FOR EACH LOT AS DEVELOPED.
- ALL SEDIMENTATION BASINS WILL BE CLEANED WHEN THE CAPACITY HAS BEEN REDUCED BY 50%. A CLEANOUT ELEVATION WILL BE IDENTIFIED ON THE PLAN AND MARKER INSTALLED ON THE SITE.
- DURING AND AFTER CONSTRUCTION, THE OWNER WILL BE RESPONSIBLE FOR THE MAINTENANCE OF PERMANENT SOIL EROSION AND SEDIMENT CONTROL MEASURES DURING AND AFTER CONSTRUCTION.
- ALL TREES TO REMAIN AFTER CONSTRUCTION ARE TO BE PROTECTED WITH TREE PROTECTION DEVICES OR SEDIMENT BARRIERS. SEE STANDARDS.
- THE SOIL CONSERVATION DISTRICT MAY REQUEST ADDITIONAL MEASURES TO MINIMIZE ON OR OFFSITE EROSION PROBLEMS DURING CONSTRUCTION.
- THE SOIL CONSERVATION DISTRICT MUST BE NOTIFIED, IN WRITING, AT LEAST 72 HOURS PRIOR TO ANY LAND DISTURBANCE.

TOPSOIL STOCKPILE PROTECTION

- CONSTRUCT TEMPORARY DIVERSION BERM AND/OR HAY BALE BARRIER AROUND STOCKPILE AREA AS REQUIRED.
- APPLY LIMESTONE AT A RATE OF 90 LBS./1,000 S.F.
- APPLY FERTILIZER (10-20-10) AT A RATE OF 11 LBS./1,000 S.F.
- APPLY PERENNIAL RYEGRASS AT A RATE OF 1 LB./1,000 S.F.
- MULCH WITH UNROTTED SALT HAY OR SMALL GRAIN STRAW IMMEDIATELY AFTER SEEDING. APPLY AT A RATE OF 90 LBS./ 1,000 S.F.

TEMPORARY STABILIZATION SPECIFICATIONS

- APPLY GROUND LIMESTONE AT A RATE OF 90 LBS./1,000 S.F.
- APPLY FERTILIZER (10-20-10) AT A RATE OF 14 LBS./1,000 S.F. AND WORK INTO SOIL 4" DEEP.
- APPLY PERENNIAL RYEGRASS AT 40 LBS./ACRE AND ANNUAL RYEGRASS AT 40 LBS./ACRE OR APPROVED EQUAL.
- MULCH WITH UNROTTED SALT HAY OR SMALL GRAIN STRAW IMMEDIATELY AFTER SEEDING AT A RATE OF 90 LBS./1,000 S.F. AND SECURE BY APPROVED METHODS (I.E. PEG AND TWINE, MULCH NETTING OR LIQUID BINDER).
- PLANT SEED BETWEEN MARCH 1 AND MAY 15 OR BETWEEN AUGUST 15 AND OCTOBER 1, IF POSSIBLE.

PERMANENT STABILIZATION SPECIFICATIONS

- APPLY TOPSOIL TO A DEPTH OF 4".
- APPLY GROUND LIMESTONE AT A RATE OF 90 LBS./1,000 S.F.
- APPLY FERTILIZER (10-20-10) AT A RATE OF 14 LBS./1,000 S.F.
- APPLY SEED MIXTURE:
PERENNIAL RYEGRASS AT 10 LBS./ACRE, KENTUCKY BLUEGRASS AT 25 LBS./ACRE, RED FESCUE AT 15 LBS./ACRE, AND SPREADING FESCUE AT 15 LBS./ACRE OR APPROVED EQUAL.
SEEDING: (STEEP EMBANKMENTS)
0.25 LBS. PER 1,000 S.F. ANNUAL RYEGRASS
0.50 LBS. PER 1,000 S.F. CROWNVEITCH
1.00 LBS. PER 1,000 S.F. CREEPING RED FESCUE
1.00 LBS. PER 1,000 S.F. CHEWING RED RESCUE - JAMESTOWN
SEEDING: (WATER TOLERANT)
0.40 LBS. PER 1,000 S.F. REED CANARY GRASS
0.10 LBS. PER 1,000 S.F. RED TOP
0.40 LBS. PER 1,000 S.F. PERENNIAL RYEGRASS
(REED CANARY GRASS MUST BE FROM NEW SEED CROP)

APPLICATION TO BE BY MECHANICAL EQUIPMENT SUCH AS A CYCLONE SPREADER.

NOTE: 72 HOURS PRIOR TO ANY SOIL DISTURBANCE, NOTICE OF SUCH IN WRITING SHALL BE GIVEN TO THE COUNTY SOIL CONSERVATION DISTRICT.

STANDARDS FOR DUST CONTROL

- DUST TO BE CONTROLLED BY EITHER (A) SPRINKLING WITH WATER OR (B) SPREADING OF CALCIUM CHLORIDE TO BE ADMINISTERED IN ACCORDANCE WITH SECTION 4.10.1 OF CHAPTER 251 " STANDARDS FOR SOIL EROSION AND SEDIMENT CONTROL IN NEW JERSEY".
- DISTURBED SOIL ON THE BANKS OF WATERWAYS SHALL BE PROTECTED WITHIN 48 HOURS OF DISTURBANCE BY RIP RAP, SANDBAGS, SOD OR APPROVED MULCH NETTING, AS CONDITIONS WARRANT, IN ACCORDANCE WITH THE "STANDARDS FOR SOIL EROSION AND SEDIMENT CONTROL".
 - ASPHALT OR OTHER LIQUID BINDERS SHALL NOT BE SPRAYED FOR MULCH ANCHORING IN SUCH AREAS.
 - CALCIUM CHLORIDE OR SPRAY ON ADHESIVES SHALL NOT BE APPLIED FOR DUST CONTROL IN SUCH AREAS.

NOTE:

SYNTHETIC FILTER FABRIC SHALL BE FIRMLY ATTACHED TO UPHILL SIDE OF FENCEPOSTS. OPEN AREA SHALL BE GREATER THAN 4% BUT LESS THAN 10% MEETING U.S. ARMY CORPS OF ENGINEERS SPEC. NO. CW02215 FOR STRENGTH. I.E. MIRAFI 140 EROSION CONTROL FABRIC OR APPROVED EQUAL.

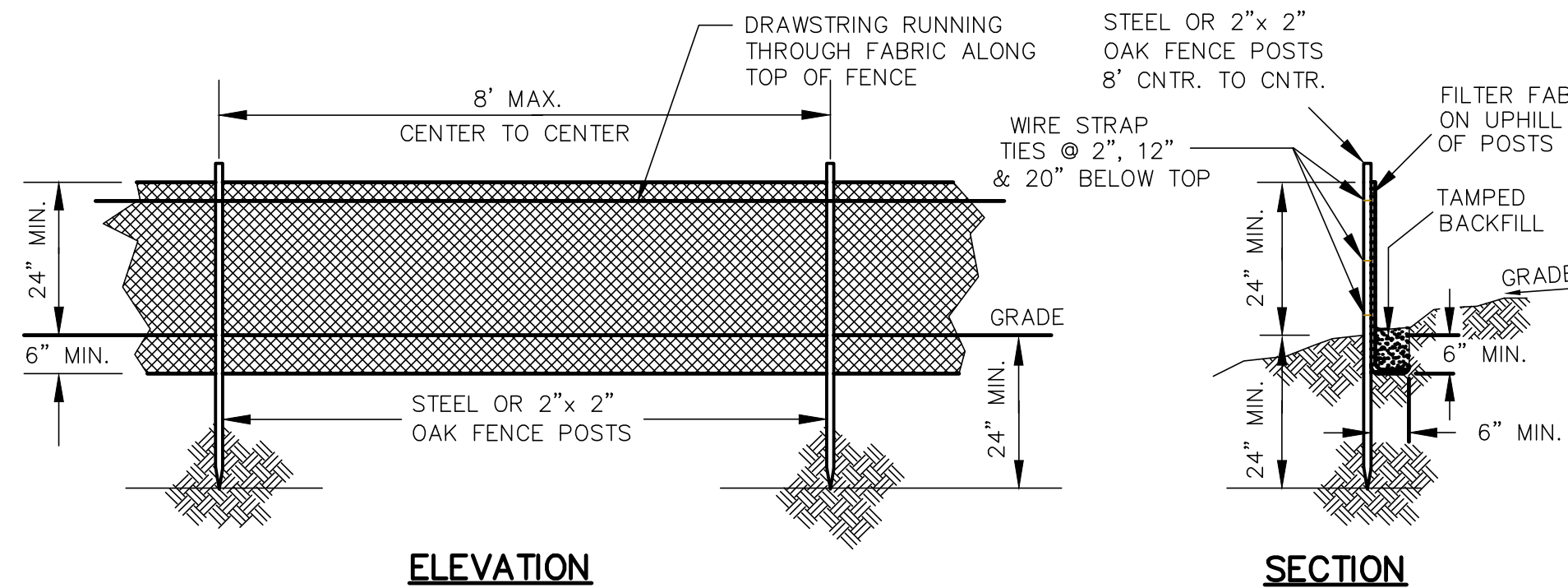

ELEVATION

SECTION

NOTE:

THE SILT FENCE MUST BE PERIODICALLY INSPECTED AND REPAIRED UNTIL THE DISTURBED AREA IS STABILIZED.

SILT FENCE
N.T.S. SE-003

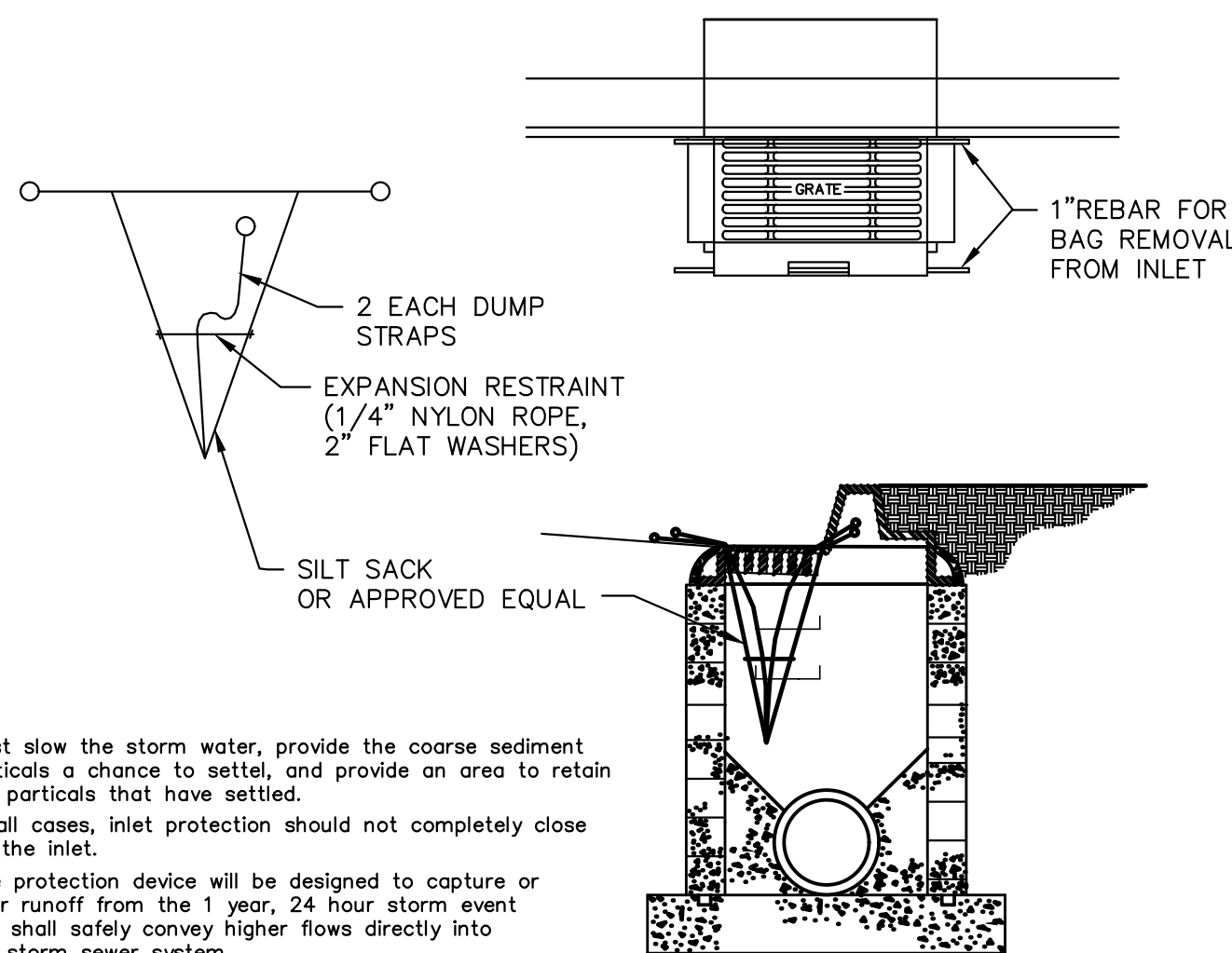

NOTES:

- Must slow the storm water, provide the coarse sediment particles a chance to settle, and provide an area to retain the particles that have settled.
- In all cases, inlet protection should not completely close off the inlet.
- The protection device will be designed to capture or filter runoff from the 1 year, 24 hour storm event and shall safely convey higher flows directly into the storm sewer system.

INLET PROTECTION

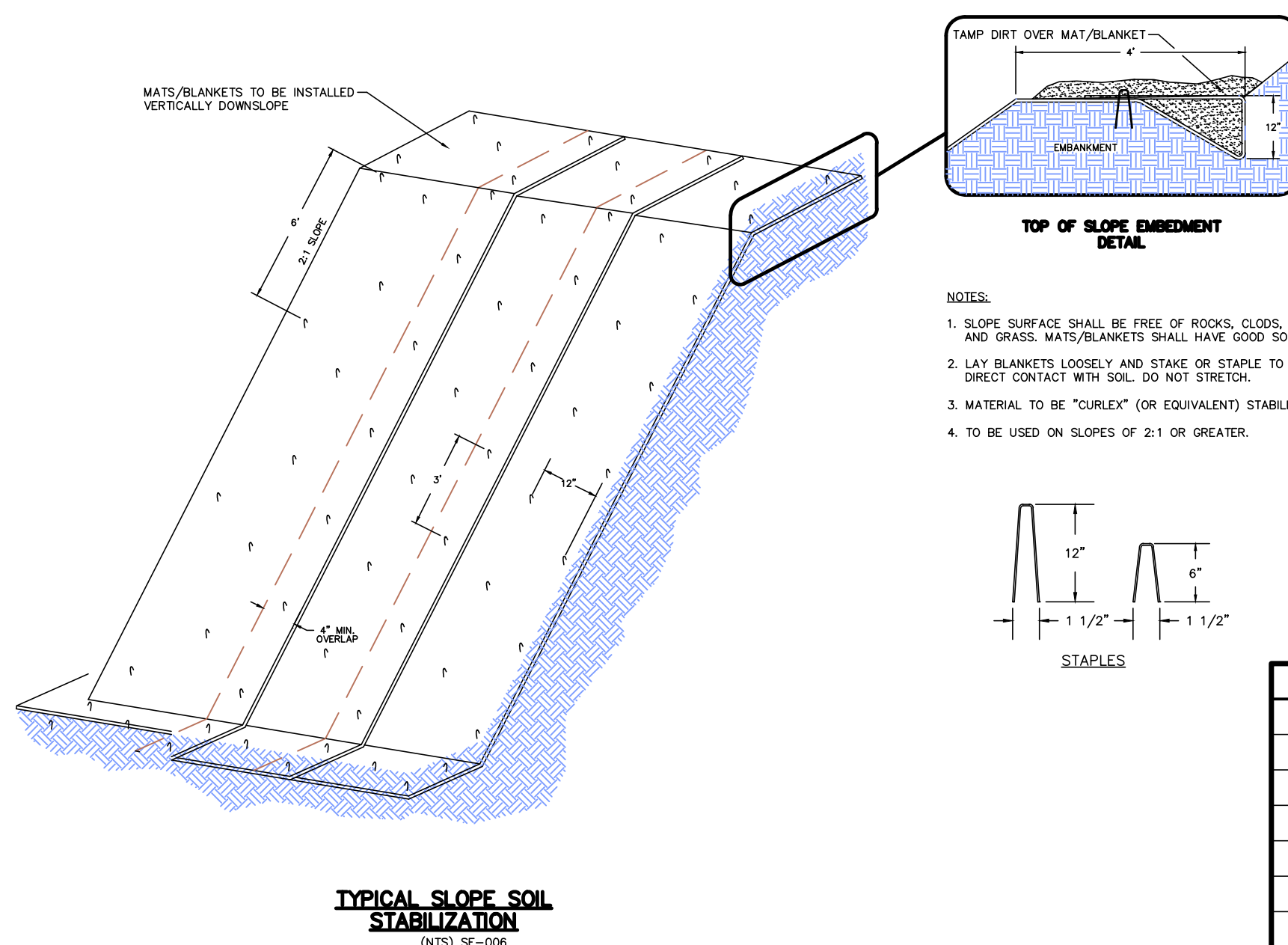

TYPICAL SLOPE SOIL STABILIZATION
(N.T.S.) SE-008

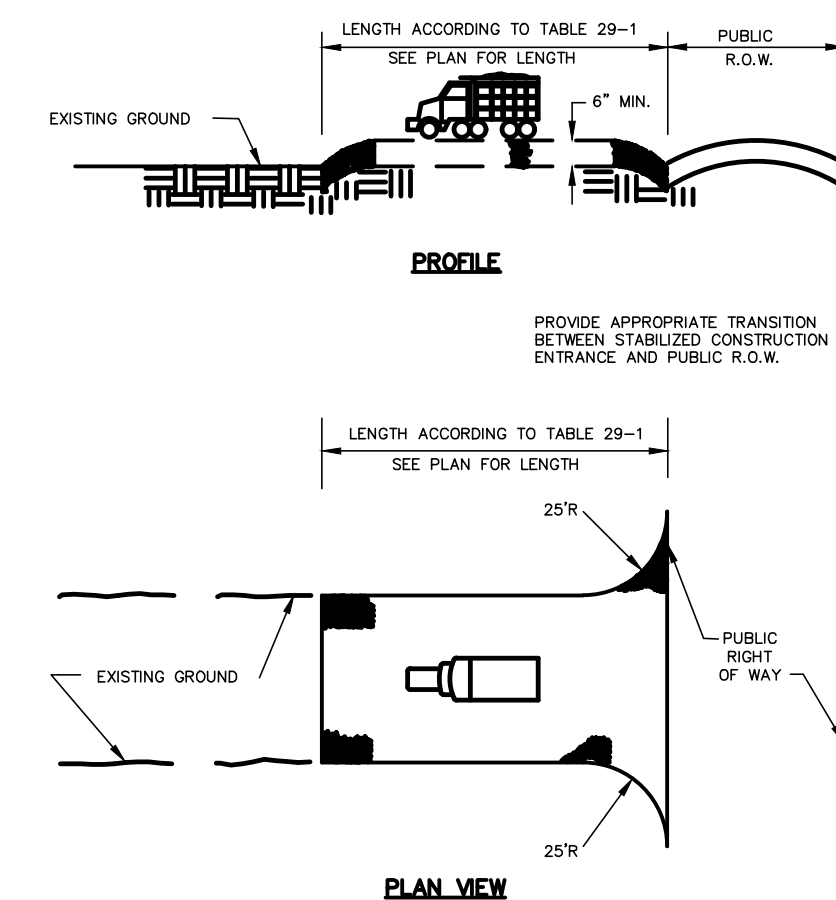

STABILIZED CONSTRUCTION ENTRANCE
N.T.S. DEF-77

TABLE 29-1
LENGTHS OF CONSTRUCTION EXITS
ON SLOPING ROADBEDS

PERCENT SLOPE OF ROADWAY	LENGTH OF STONE REQUIRED	
	COARSE GRAINED SOILS	FINE GRAINED SOILS
0 TO 2%	50 FT.	100 FT.
2 TO 5%	100 FT.	200 FT.
>5%	ENTIRE SURFACE STABILIZED WITH FABC BASE COURSE	

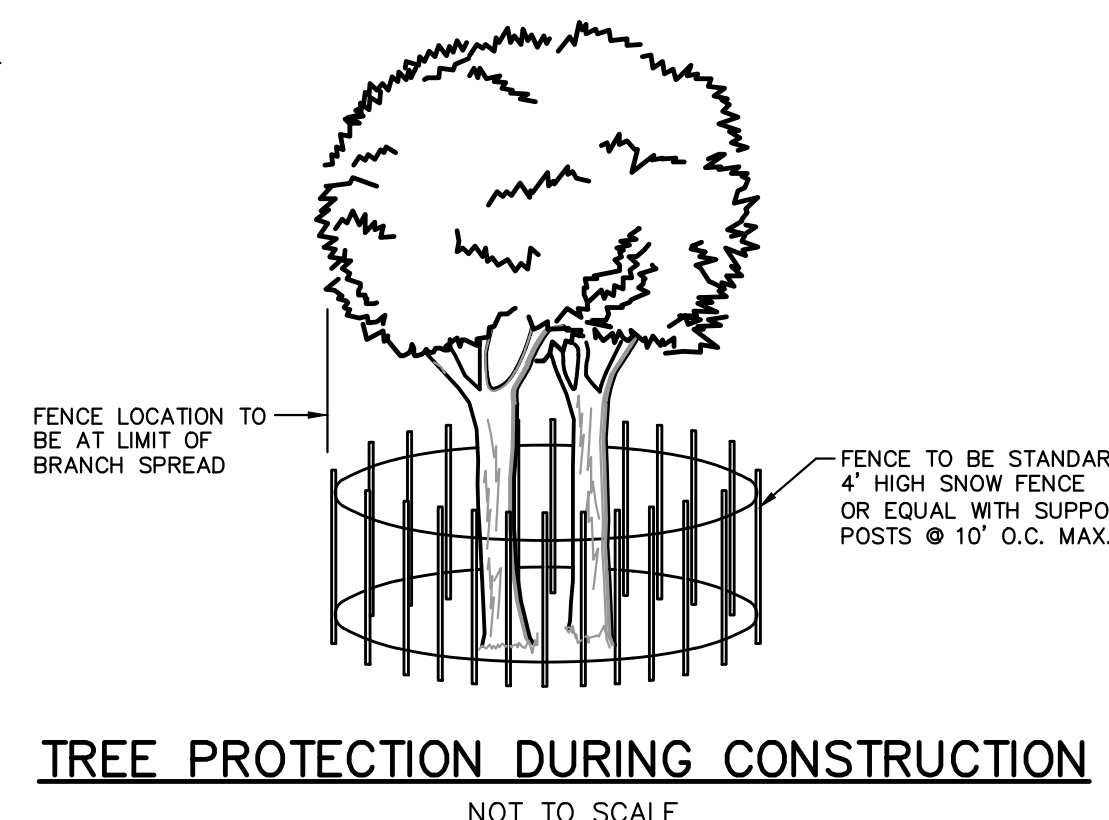

TREE PROTECTION DURING CONSTRUCTION
NOT TO SCALE

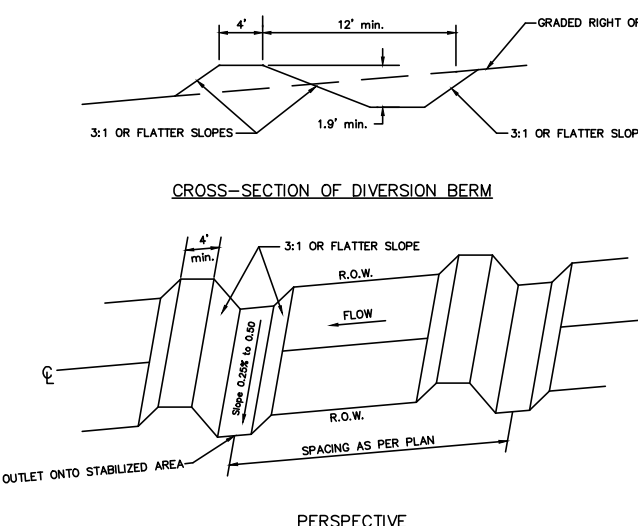

CROSS-SECTION OF DIVERSION BERM
PERSPECTIVE
DESIGN CRITERIA:
TOP WIDTH = 4' MIN.
HEIGHT = 4' MIN. (height measured from the bottom line to top of mat)
SLOPE = 3:1 TO 5:1 (slope steep enough to allow construction traffic to cross)
GRADE = 2% TO 5%
GRADING = 12 per pass
GENERAL NOTES:
1. Top width may be wider and slope steeper if needed.
2. Diverted runoff shall collect into an undisturbed stable area, or into the outlet onto stabilized area.
3. Periodic inspection and required maintenance must be provided.

SMALL DIVERSION FOR GRADED RIGHT-OF-WAY

SE-007

NOTES

- THE DISTRICT SHALL BE REPRESENTED AT THE PRECONSTRUCTION MEETING WITH THE TOWNSHIP ENGINEER, CONTRACTORS, AND UTILITY REPRESENTATIVE. IF THE TOWN ENGINEER DOES NOT SCHEDULE A PRECONSTRUCTION MEETING, IT IS THE RESPONSIBILITY OF THE OWNER/APPLICANT TO SCHEDULE ONE PRIOR TO ANY LAND DISTURBANCE.
- THE OWNER/APPLICANT WILL OBTAIN THE DISTRICT ISSUED REPORT OF COMPLIANCE PRIOR TO ANY OCCUPANCY. THE DISTRICT REQUIRES AT LEAST ONE WEEK'S NOTICE BEFORE ISSUANCE.
- ALL REVISIONS, AFTER DISTRICT CERTIFICATION HAS BEEN GRANTED, SHALL BE FORWARDED TO THE SOIL CONSERVATION DISTRICT FOR REVIEW. A LETTER OF EXPLANATION SHALL ACCOMPANY ALL REVISIONS.
- ALL TOPSOIL STRIPPED AND STOCKPILED FOR USE IN FINAL GRADING SHALL RECEIVE TEMPORARY SEEDING.
- THE APPLICANT IS REQUIRED TO HAVE A COPY OF THE CERTIFIED PLAN AT THE CONSTRUCTION SITE.
- TO THE MAXIMUM EXTENT PRACTICAL, ALL VEGETATED AREAS NOT NEEDED FOR CONSTRUCTION SHALL BE LEFT UNDISTURBED FOR AS LONG AS POSSIBLE.
- FINAL STABILIZATION OF ALL LAND DISTURBANCES ASSOCIATED WITH UNDERGROUND UTILITIES, IRRESPECTIVE OF PHASING, IS THE ULTIMATE RESPONSIBILITY OF THE OWNER.

DATE	REVISIONS	MADE

SOIL EROSION & SEDIMENT CONTROL NOTES AND DETAILS
BLANK 526, LOT 12
TOWNSHIP OF VERNON, SUSSEX COUNTY, NEW JERSEY
G. Gloede and Associates
POST OFFICE BOX 449, OAK RIDGE, NEW JERSEY 07438, (973)697-9247
George R. Gloede Jr.
GEORGE R. GLOEDE JR.
Professional Engineer Lic. No. 32407

FILE NO.	2020-37
DATE:	FEB. 11, 2021
SCALE:	AS SHOWN
DRAWN BY:	CAD
CHECKED BY:	GRG
DRAWING NO.	SCDDetail
SHEET NO.	2 OF 2