

VERNON TOWNSHIP LOT DEVELOPMENT PLAN PERMIT APPLICATION

For Premises Located _____ Block _____ Lot _____

Development Name: _____ New Construction () Addition ()

COMPLETE THE BELOW IN ITS ENTIRETY & CIRCLE PREFERENCE OF COMMUNICATION

Contact Person: _____ Phone# _____ Cell# _____

Mailing Address: _____ E-mail _____

Owners Name: _____

Engineer: _____ Phone# _____ Fax# _____

Mailing Address: _____ E-mail _____

Prior to the issuance of a construction permit by the Construction Official for any new structure on any undeveloped residential lot or for an addition or accessory structure larger than 500 square feet on a developed residential lot or any commercial lot not subject to Planning and Zoning approval, a permit for a Lot Development Plan (LDP) shall be applied for and issued by the Township Engineer.

Applicant shall provide the following:

1. **One (1) completed application form including checklist**
2. **Administrative Checklist, Technical Checklist and all items required therein.**
3. **Application filing fees:**
 - **New Construction = \$450.00**
 - **Additions = \$250.00**
4. **Fee is due upon submission of application. Please make check payable to Vernon Township.**
Check # _____ Cash \$ _____ Receipt # _____ Amt\$ _____

Signature of Applicant _____ Date _____

***Note- Zoning Permits are required with the submission of all LDP permits. The fee for a Zoning Permit is \$50.00**

For Official Use Only:

Approval is granted and a **Lot Development Permit** is hereby issued in accordance with Article 18 of the Vernon Township Land Use Ordinance.

Plans prepared by: _____ Dated: _____ Last Revised: _____

The Following approvals are granted:

Preliminary Soil Conservation () Preliminary Road Opening () Stream Buffer ()

Prior to CO: Final Soil Conservation, Road Opening, Drywell & Grading inspections are required.

Vernon Township Engineer Date _____ Permit No. _____

rev. 7/27/21

VERNON TOWNSHIP LOT DEVELOPMENT PERMIT ADMINISTRATIVE CHECKLIST

APPLICANT: _____ STREET ADDRESS: _____

BLOCK: _____ LOT: _____

NEW SINGLE FAMILY

- _____ 1. A completed application form.
- _____ 2. Application filing fee of \$450.00 & \$250.00 for Soil Erosion & Sediment Control.
- _____ 3. Three (3) sets of plans prepared by a New Jersey licensed Professional Engineer.
- _____ 4. A copy of a survey prepared by a New Jersey Licensed Professional Land Surveyor.
- _____ 5. A completed Technical Checklist
- _____ 6. A completed Administrative Checklist.

ADDITIONS

- _____ 1. A completed application form.
- _____ 2. Application filing fee of \$250.00.
- _____ 3. Three (3) copies of the location survey depicting the proposed improvements and the proposed drywells. NOTE: Homeowner may sketch improvements on the survey.
- _____ 4. Four (4) color photographs depicting the area being disturbed.
- _____ 5. A completed Administrative Checklist.

NOTES: _____

**VERNON TOWNSHIP LOT DEVELOPMENT PLAN
TECHNICAL PERMIT CHECKLIST
TO BE COMPLETED BY APPLICANT'S ENGINEER**

Applicant's Name: _____

Street Address: _____ Block _____ Lot _____

- _____ 1. Key Map based on Tax Map of Vernon Township, with parcel indicated.
- _____ 2. Topography of lot and adjacent street, 2 feet contours based on actual field survey, performed by a licensed professional land surveyor.
- _____ 3. Existing streams, ponds, watercourses, wetlands, buffers and LOI reference.
- _____ 4. Existing storm sewers, detention basins and easements.
- _____ 5. Zoning table, with required and proposed bulk requirements.
- _____ 6. All proposed new structures, walkways and stairs.
- _____ 7. Proposed driveway location, parking, turn-a-rounds & driveway profile.
- _____ 8. Elevations of finished first floor, garage floor and lowest floor.
- _____ 9. Drywell locations and sizing calculations (3" rainfall).
- _____ 10. Septic system location and components.
- _____ 11. Proposed water well location.
- _____ 12. Proposed grading and proposed contours (Scale 1" = 30' or less), elevations at building corners. Proposed drainage pipes and swales.
- _____ 13. Proposed retaining wall locations and details; top and bottom elevations.
- _____ 14. Available driveway site distances (Field measured).
- _____ 15. Wooded areas.
- _____ 16. Swales to divert surface water away from buildings and disposal beds.
- _____ 17. Side slopes, 2:1 max (stabilization matting required) 3:1 preferred.
- _____ 18. NJDEP requirements, if applicable.
- _____ 19. Soil erosion measures and details, tracking pad, silt fence, topsoil stockpile, etc.
- _____ 20. Required setback lines.
- _____ 21. Driveway detail (pavement required if grade is greater than 8%)

Engineers Signature: _____

Date: _____

SIZE REQUIREMENTS:

FOR ADDITIONS/GARAGES
6' WIDE x 6' DEEP

FOR NEW HOMES:

SEE ENGINEERS DESIGN
PLAN (L.D.P.)
SIZE FOR 3" RAINFALL

NOTE:

DRYWELL MUST BE
LOCATED A MINIMUM OF
50' FROM ALL EXISTING
OR PROPOSED WELLS +
SEPTICS

Figure 9.3-1: Dry Well Components

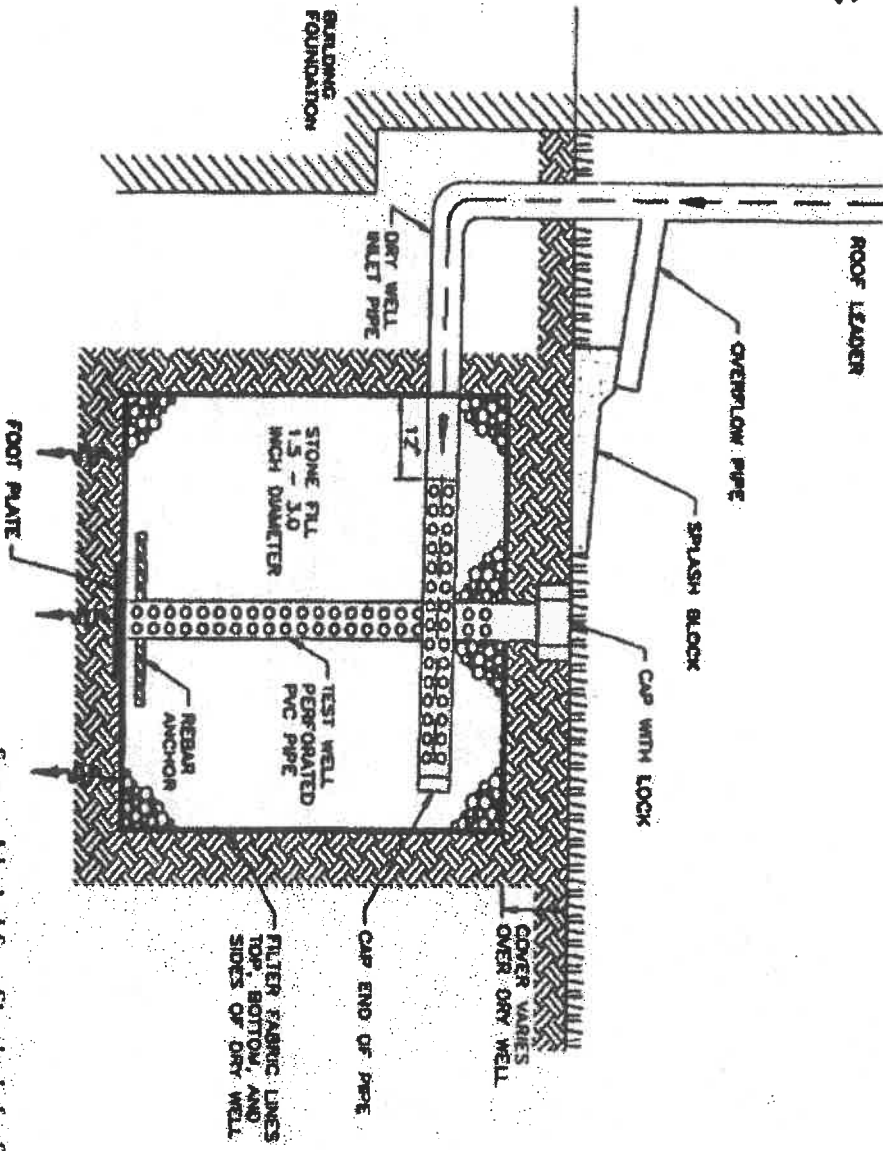

Source: Adapted from Standards for Soil Erosion and Sediment Control in New Jersey

NOTE:

THIS DETAIL CAN BE UTILIZED, OR A PRECAST CONCRETE TANK